

NONPROFIT ORGANIZATION
 U. S. POSTAGE
PAID
 Schoolcraft College

Schoolcraft College
 Continuing Education and
 Professional Development
 18600 Haggerty Road
 Livonia, MI 48152-2696

Board of Trustees

Gregory J. Stempien.....Chair
 Brian D. Broderick.....Vice Chair
 Carol M. Strom.....Secretary
 Patricia Watson.....Treasurer
 Mary Breen.....Trustee
 Philip N. Cascade.....Trustee
 Joan A. Gebhardt.....Trustee
 Conway A. Jeffress, President



Test preparation workshops offering
 the advantages of higher-priced courses
 at an affordable cost

GRE

Graduate Record Exam

GMAT

Graduate Management
 Admissions Test

LSAT

Law School Admissions Test

**2010-2011
 Test Preparation
 Workshops**



Schoolcraft College
 Continuing Education and
 Professional Development/
 Learning Assistance Center

Our test preparation workshops feature the most up-to-date materials and a highly effective approach to achieving higher scores, including:

- Diagnostic pre-testing and personal assessment
- Remedial review
- In-class problem-solving, concepts and strategies
- Practice test reinforcement
- Post-exam and final personal assessment

Each workshop begins with a diagnostic test, using actual retired exams. Not only will students have this first-hand test-taking experience, the test results will generate a personalized score report that shows areas of strengths and weaknesses. This personal score report will be provided to each student at the second class meeting, to help determine the study approach necessary for success.

Students in GRE, GMAT or LSAT Workshops receive:

- Diagnostic exam, using actual retired tests.
- Personal score report.
- Student textbook.
- CD-ROM with computer-adaptive practice tests that automatically adapt to the students' proficiency level as they progress through the tests.
- In-class problem solving, concepts and essential strategies for answering difficult questions.
- Review of each required testing point.
- Post-exam, using actual retired tests.
- Additional personal score report showing student's progress, sent to the student after completion of the workshop.

Some comments from our students:

"Good format and presentation. I especially liked the pre- and post-test analysis."

"The instructors were the most valuable aspect of this course. They both went above and beyond the call of duty. They were friendly, knowledgeable and accessible."

"Explanations in the book and by the instructors, plus learning new techniques that I wasn't aware of, were most helpful to me."

Please note: Student success is dependent upon class participation as well as ample study time outside of class.

It is the policy of Schoolcraft College that no person shall, on the basis of race, color, national origin, gender, age, marital status, creed or handicap, be excluded from participating in, be denied benefits of, or be subjected to discrimination during any program or activity or in employment.

Continuing Education and Professional Development/Learning Assistance Center

TEST PREPARATION WORKSHOPS

GRE PREPARATION WORKSHOPS

CES 0857 8 Sessions—32 hours of classroom time
 Fee: \$395 (\$316 Senior Adult)
 Cost includes textbook and CD-ROM
 with computer-adaptive practice tests

3 workshops are scheduled for 2010–2011:

Saturdays, September 18–November 6, 2010

Section 946212 9 am–1 pm
 Livonia Campus
 Room: LA 425

Saturdays, February 19–April 16, 2011

Section 916220 9 am–1 pm
 Livonia Campus
 (no class February 26) Room: *To Be Announced*

Saturdays, April 30–June 25, 2011

Section 926232 Saturdays 9 am–1 pm
 Livonia Campus
 (no class May 28) Room: *To Be Announced*

GMAT PREPARATION WORKSHOPS

CES 0850 8 Sessions—32 hours of classroom time
 Fee: \$395 (\$316 Senior Adult)
 Cost includes textbook and CD-ROM
 with computer-adaptive practice tests

3 workshops are scheduled for 2010–2011:

Saturdays, September 18–November 6, 2010

Section 946206 9 am–1 pm
 Livonia Campus
 Room: LA 420

Saturdays, February 19–April 16, 2011

Section 916224 9 am–1 pm
 Livonia Campus
 (no class February 26) Room: *To Be Announced*

Saturdays, April 30–June 25, 2011

Section 926233 Saturdays 9 am–1 pm
 Livonia Campus
 (no class May 28) Room: *To Be Announced*

*Please note: Schoolcraft College does not administer these exams.
 For testing information please go to www.gre.org, www.gmat.org
 or www.lsatsat.org*

- Please call 734-462-4436 for information on room location.
- Please arrive at the first class on time, prepared to test.
 Bring #2 pencils.

LSAT PREPARATION WORKSHOPS

CES 0851 8 Sessions—32 hours of classroom time
 Fee: \$395 (\$316 Senior Adult)
 Cost includes textbook and CD-ROM
 with computer-adaptive practice tests

2 workshops are scheduled for 2010–2011:

To prepare for the December 11, 2010 exam:

Saturdays, September 25–November 13, 2010
 Section 946202 9 am–1 pm
 Livonia Campus
 Room: LA 405

To prepare for the June 2011 exam:

Saturdays, March 26–May 21, 2011
 Section 916231 9 am–1 pm
 Livonia Campus
 (no class April 23) Room: *To Be Announced*

Important—Please enroll early!

Complete the attached registration form, including CES and Section numbers, and mail or walk in to our Admissions and Enrollment Center in the McDowell Center. In order for us to have the appropriate number of materials on hand for the first day of class, return the form at least three days before the class starts. **Students registering later are not guaranteed pre-test or other course materials at the first class meeting.**

Please note college refund policy: Through the day before the first class, 100 percent refund. Thereafter, no refund.

For more information please contact the Learning Assistance Center at 734-462-4436 or e-mail us at lac@schoolcraft.edu.

Schoolcraft College
 18600 Haggerty Road, Livonia, MI 48152-2696
between Six and Seven Mile Roads

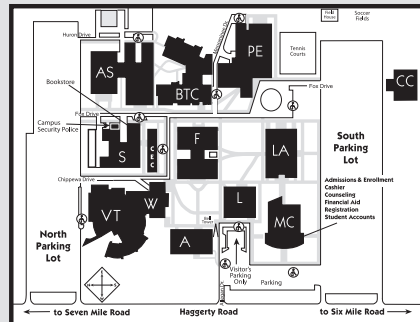

GRE/GMAT/LSAT 2010/2011

Please use one registration form per student. Duplicate this form as needed.

1. Are you Hispanic? Yes No
2. Please select one or more races:
 American Indian or Alaska Native Asian Black or African American
 Native Hawaiian or Other Pacific Islander White

Date of Birth _____ Student Number _____ OR SS# _____ Last 4 digits _____
To be assigned to first-time students

Company-paid Tuition: Please send a copy of your purchase order when you register.

Co. Name _____
 Co. Address _____
 Billing Contact Person _____
 PO# _____
 For office use only _____

Gender: Male Female

First Name _____ MI/Former _____ State _____ City _____ Zip _____

Last Name _____ Street _____

Day Phone _____ Evening Phone _____ Cell Phone _____

Section No. _____ CES No. _____ Title of Course _____

AMT: \$ _____
 AMT: \$ _____
 AMT: \$ _____
 AMT: \$ _____
 Total: \$ _____

- Enclosed is my Check/Money Order payable to Schoolcraft College
 - Charge to VISA/MC/Discover No. _____ Exp. Date _____
- Signature required for charge card payment _____

Mail to: Schoolcraft College/Cashier: CE
 18600 Haggerty Rd., Livonia, MI 48152-2696