

SCHOLARSHIPS

SCHOOLCRAFT COLLEGE CAREER CHALLENGE SCHOLARSHIPS

Schoolcraft College awards Career Challenge Scholarships to recognize the academic achievement of students earning a GED at Schoolcraft. These awards are intended to encourage potential students to enroll at Schoolcraft and explore career options while taking classes. Schoolcraft College encourages outstanding recent recipients of the GED to apply for this award. The college has a wide variety of support services to assist new students with academic success and career opportunities. It's time to meet the challenge!

- You qualify by earning a minimum score of 500 on each part of a GED test taken at Schoolcraft College within the past 12 months.
- You must be admitted to Schoolcraft College and also complete the Career Assessment Inventory at Schoolcraft College Career and Transfer Center.

Scholarship recipients receive \$500 for tuition, fees, books and supplies to be used within the academic year it is awarded.

For further information and an application form, contact the Testing Center at 734-462-4806.

It is the policy of Schoolcraft College that no person shall, on the basis of race, color, national origin, gender, age, marital status, creed or handicap, be excluded from participating in, be denied benefits of, or be subjected to discrimination during any program or activity or in employment.

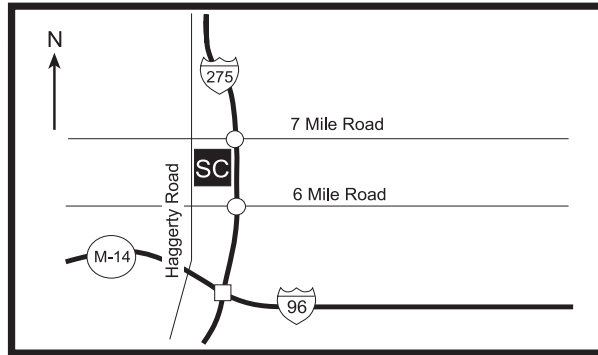

SCHOOLCRAFT COLLEGE CAMPUS

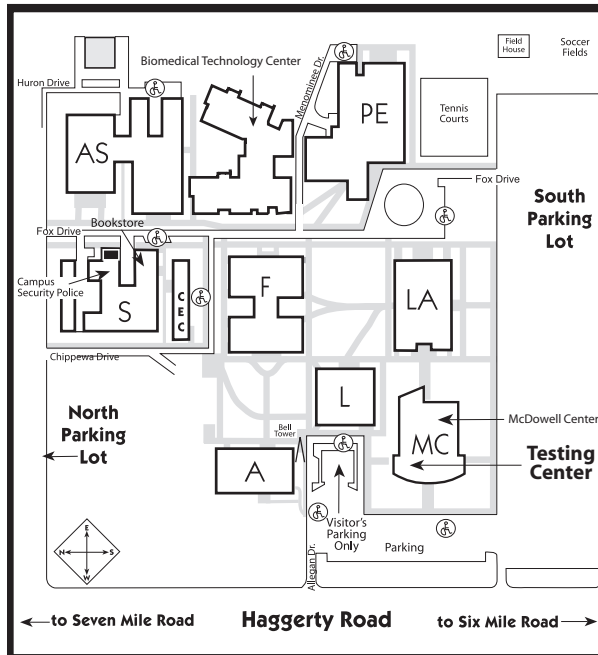

SCHOOLCRAFT TESTING CENTER

Schoolcraft College
McDowell Center
Testing Center – Room 220
18600 Haggerty Road
Livonia, MI 48152
(734) 462-4806

TEST INFORMATION

GED

General Education Development Test

INFORMATION and SCHEDULE



**Schoolcraft
College**

SCHOOLCRAFT COLLEGE TESTING CENTER

www.schoolcraft.edu/assessment

2012 GED TESTING SESSIONS

First-time GED candidates must take all five (5) tests by attending one of the two-day, consecutive testing sessions below.

■ FIRST-TIME TESTING

Time: 9:00 a.m. – 2:00 p.m., both days,
Wednesday and Thursday

January 18 and 19

February 8 and 9

March 7 and 8

April 11 and 12

June 6 and 7

July 11 and 12

August 8 and 9

September 12 and 13

October 10 and 11

November 14 and 15

■ RETAKES

Retesting is available for anyone who tested since January 1, 2002. A maximum of three (3) exams per subject is allowed in one calendar year.

Time: 9:00 a.m.....Mathematics
11:30 a.m.....Science, Social Studies,
Reading
1:00 p.m.....Writing

February 29

June 13

September 19

November 28

HOW TO REGISTER

Please call (734) 462-4806 for an appointment.

Registration for first-time test takers will be done in person at:

**Schoolcraft College
McDowell Center
Testing Center – Room 222
18600 Haggerty Road
Livonia, MI 48152**

WHEN REGISTERING

Please bring the following with you to register:

- A government-issued, photo ID such as a driver's license, passport or state ID.
- Your social security number
- Your email address
- Payment for the exam: \$150 for first-time testing, cash, credit, or check

Registration takes approximately one (1) hour and includes creating a user name and password and filling out required forms.

GED TEST REGISTRATION FEE

GED Test Registration: **\$150**

Exam Retake Fee: **\$30 per subject**

Fees must be submitted with Registration Form. Tests may be rescheduled once without additional payment. A rescheduling fee of \$10 will apply thereafter.

Test fees are nonrefundable and are subject to change.

GED PREPARATION

■ WORKSHOPS

Contact the Continuing Education Department at 734-462-5407 or email cepd@schoolcraft.edu.

■ WEBSITES

- www.gedpractice.com
- www.acenet.edu

THE GED PROGRAM

The GED Program is a series of five tests that measures knowledge and skills typically learned during high school.

■ DAY 1

Language Arts, Writing Skills.....Two Hours
(Parts I & II)

Mathematics

Part 1 (calculator) 45 min.

Part 2 (no calculator) 45 min.

Casio fx 260 Solar Calculator is supplied for the Mathematics Test, Part 1.

■ DAY 2

Science..... One Hour, 20 min.

Social Studies One Hour, 10 min.

Reading Information Test..... One Hour, 5 min.

REQUIREMENTS

- Government photo identification verifying age and signature is required for admission to the test session.
- Social Security Number
- Individuals who are at least 16 years of age and have been out of a regular school program for one calendar year may be tested. Please contact the Testing Center at 734-462-4806 for information regarding when the calendar year may be waived for testing.

ISSUANCE OF CERTIFICATE

- The passing standard score must be a minimum of **410 on each** of the five tests.
- Candidates must attain an average standard score of **450 for all five tests**.
- Candidates must be 18 years old and their high school class must have graduated to be eligible for a GED certificate.

GED testing accommodations are available for eligible individuals with physical or learning disabilities.

PLEASE CHECK
www.schoolcraft.edu/assessment
for schedule updates. Dates and times are subject to change.