



Schoolcraft College
Testing Center
18600 Haggerty Road
Livonia, MI 48152-2696

NONPROFIT ORGANIZATION
U.S. POSTAGE
PAID
Schoolcraft College

Board of Trustees

- Gregory J. Stempien.....Chair
- Brian D. Broderick.....Vice Chair
- Carol M. Strom.....Secretary
- Patricia Watson.....Treasurer
- Mary Breen.....Trustee
- Philip N. Cascade.....Trustee
- Joan A. Gebhardt.....Trustee
- Conway A. Jeffress, President

2010 Test Information

GED

**General Education
Development Test**

Testing Program

- Information
- Schedule
- Registration



Schoolcraft College

Testing Center
www.schoolcraft.edu/assessment

Schoolcraft College Campus

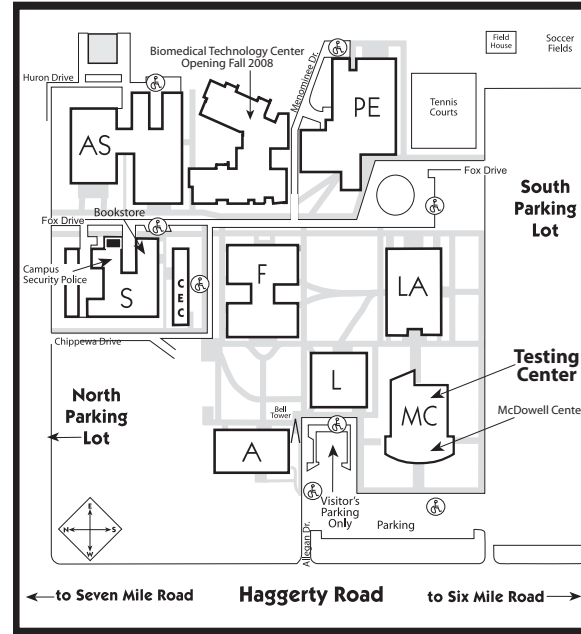
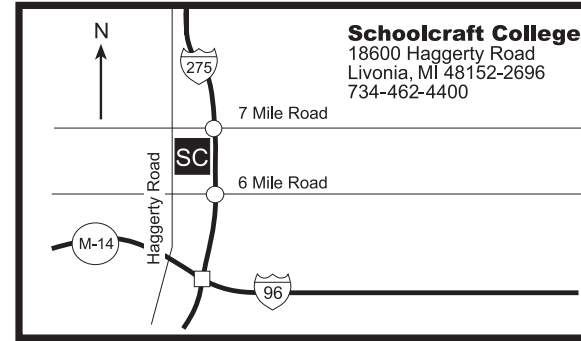

It is the policy of Schoolcraft College that no person shall, on the basis of race, color, national origin, gender, age, marital status, creed or handicap, be excluded from participating in, be denied benefits of, or be subjected to discrimination during any program or activity or in employment.

Schoolcraft College

**CAREER CHALLENGE
SCHOLARSHIPS**

for GED Graduates

Schoolcraft College awards Career Challenge scholarships to recognize the superior academic achievement of area students earning a GED at Schoolcraft. These awards are intended to encourage potential students to enroll at Schoolcraft and explore career options while taking classes. Schoolcraft College encourages outstanding recent recipients of the GED to apply for this award. The college has a wide variety of support services to assist new students with academic success and career opportunities. It's time to meet the challenge!

You qualify by earning a minimum score of 500 on each part of a GED test taken at Schoolcraft College within the past 12 months. You must be admitted to Schoolcraft College and also complete the Career Assessment Inventory at Schoolcraft College Career and Transfer Center.

Scholarship recipients receive \$500 for tuition, fees, books and supplies to be used within the academic year it is awarded.

For further information and an application form, contact the Testing Center at 734-462-4806.

GED 2010 Program is a series of five tests that measures knowledge and skills typically learned during high school.

Day 1

Language Arts, Writing Skills (Parts I & II)..... Two Hours
 Mathematics Test

Part 1 (calculator)..... 45 min.

Part 2 (no calculator) 45 min.

Casio fx 260 Solar Calculator is supplied for the Mathematics Test, Part I.

Day 2

Science..... One Hour, 20 min.

Social Studies One Hour, 10 min.

Reading Information TestOne Hour, 5 min.

Requirements:

- State or government photo identification verifying age and social security number is required for admission to the test session.
- Individuals who are at least 16 years of age and have been out of a regular school program for one calendar year may be tested. Please contact the Testing Center at 734-462-4806 for information regarding when the calendar year may be waived for testing.

Issuance of Certificate:

- The passing standard score must be a minimum of **410 on each** of the five tests.
- Candidates must attain an average standard score of **450 for all five tests**.
- Candidates must be 18 years old and their high school class must have graduated to be eligible for a GED certificate.

GED testing accommodations are available for eligible individuals with physical or learning disabilities.

GED Test Registration Fee: \$150

Fees must be submitted with Registration Form.

2010 Exam Retake Fee \$30 per exam

Test fees are nonrefundable and are subject to change.

GED Preparation Workshops:

Contact the Learning Assistance Center at 734-462-4436 or email lac@schoolcraft.edu.

GED Preparation Websites:

www.gedpractice.com
 www.acenet.edu

GED Testing Registration Form–2010 Testing Program

Detach Registration Form and return with CHECK or MONEY ORDER payable to:

Testing Center
 Schoolcraft College
 18600 Haggerty Road
 Livonia MI 48152-2696

First-time GED candidates

First-time GED candidates must take all five (5) tests by attending the two consecutive days listed below. Contact the Testing Center at 734-462-4806 for any additional information or to arrange testing accommodations.

Please select one testing session: (Arrive 15 minutes before start time)

**Wednesday & Thursday
 Daytime Testing 9:00 am–2:30 pm**

- ____ January 13 & 14, 2010 _____ July 14 & 15, 2010
- ____ February 10 & 11, 2010 _____ August 11 & 12, 2010
- ____ March 10 & 11, 2010 _____ September 15 & 16 2010
- ____ April 6 & 7, 2010 *(T & W) _____ November 10 & 11, 2010
- ____ May 26 & 27, 2010 (MC110)

** Due to scheduling conflict these test dates are Tuesday and Wednesday morning*

**Wednesday & Thursday
 Evening Testing 5:00–9:30 pm**

- ____ June 2 & 3, 2010
- ____ October 6 & 7, 2010

As Scheduled

Retakes

- 9:00 am–2:30 pm**
- ____ March 19, 2010 (F)
- ____ June 8, 2010 (T)
- ____ August 13, 2010 (F)
- ____ October 12, 2010 (T)
- ____ December 1, 2010 (W)

State or government photo identification verifying age is required for admission to the test session. Only 20 seats available per test session. Registration accepted with payment only. Test fee is nonrefundable. No late admittance to test session will be permitted.

GED retest candidates

Retesting is available for anyone who tested since Jan 1, 2002.

If this is a retest, when and where did you take the last GED? Date (month/year) ____ / ____ Test Center _____

(This information is required)

Social Security # ____ - ____ - ____ / ____ / ____ / ____
 (last 4 digits)

Date of Birth ____ / ____ / ____

Last _____ First _____ MI/Former _____

Number _____ Street _____ City _____ State _____ Zip _____

Home Phone _____ Work Phone _____

Check the test(s) you need below:

Fees**First-time candidate - All five tests (2-day session) .. \$ 150.00**.....AMT: \$ _____
 _____ Writing Skills \$ 30.00.....AMT: \$ _____
 _____ Mathematics \$ 30.00.....AMT: \$ _____
 _____ Science \$ 30.00.....AMT: \$ _____
 _____ Social Studies \$ 30.00.....AMT: \$ _____
 _____ Reading Information \$ 30.00.....AMT: \$ _____

Enclosed is my check or money order payable to Schoolcraft College in the amount of..... Total: \$ _____

Confirmation _____